



Creative Fabrica

**Embroidery Design
Sewing Information**

www.creativefabrica.com/embroidery/

© Creative Fabrica

MACHINE EMBROIDERED CLOTH CHARACTERS



WITH INSTRUCTIONS

by

BALLYHOO
Creations

VIDEO TUTORIAL

A video tutorial is available for this project at <https://www.creativefabrica.com/teacher/ballyhoo-creations/> (a paid membership may be required for viewing the video)

TOOLS

- Embroidery machine with hoops large enough for the body design
- Sharp fabric scissors
- Hemostats (small nosed for small parts, and larger ones for larger parts)
- Machine needle - size 14 may work better with thick materials
- 3" doll needle or longer recommended for hand sewing
- Wire cutters and needle nose pliers for the wire armature
- Fabric pins or clips
- Fine-point White paint pen for eyes (optional)

SUPPLIES NEEDED:

- No-show mesh embroidery stabilizer for body and head
- Tear-away or soluble stabilizer for ears, hands and hat
- Stretchy Body fabric - fleece, scuba, minky, jersey
- Stretchy face, hands and ears fabric
- Mohair locks or other fiber for hair
- Top & bobbin thread to match body and face color for seams
- Strong thread for hand sewing
- Quality Stuffing {Mountain Mist brand is preferred over Polyfil brand}
- Thick & Thin Armature wire and electrical tape {optional}
- Chenille Stems to wire fingers (optional)
- Fabric glue
- Fur Yarn Trim (Lion Brand Go for Faux used in photos)
- Small earth magnets for hands and feet (optional)
- Tiny buttons (optional)

cut-away stabilizer MUST be used on front and back of doll body and head to prevent distortion when stuffing the doll. The ears, hands and hat don't need stabilizer on their finished pieces.

INSTRUCTIONS: FOR STITCHING EARS

Note: the ears are optional - but they sure do look cute!

(Ears are not available for the small size doll stitched in 5x7 hoops.)

1. Hoop some tear-away or soluble stabilizer in 4x4 hoop.
2. STITCH COLOR 1 to create a placement guide on the stabilizer. Note the arrow showing direction of stretch for your fabric.
3. Place the front piece of ear fabric, RIGHT SIDE UP, to cover the placement stitches.
4. STITCH COLOR 2 to create the inner ear details.
5. Place the back piece of ear fabric RIGHT SIDE DOWN over the front piece.
6. STITCH COLOR 3 to stitch the ear seams.
7. Gently tear the ears away from the stabilizer and cut them out. Use a scant 1/8" seam allowance for this which is safe as long as you're using a non-fray stretch fabric. For the open end of the ear, cut straight across and as close to the seams as you can. (this will help with positioning later on)
8. Use small nosed hemostats to turn the ears right side out and push out all the seams and corners.

Put the ears aside - they will be stitched into the head in the next section.

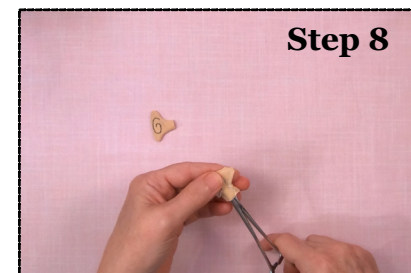
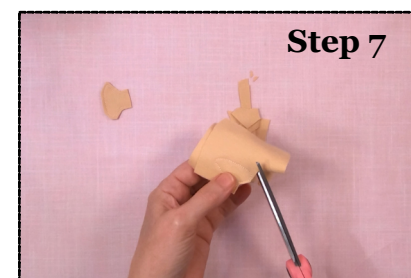
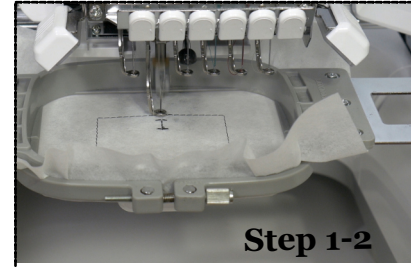
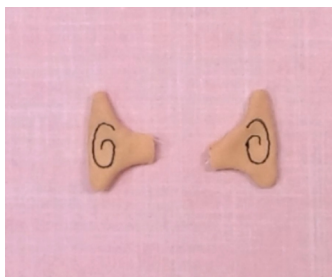

INSTRUCTIONS: STITCHING THE HEAD

You will need to have the ears finished to complete the head. (or you can omit the ears, but they sure are cute!)

1. Hoop no-show mesh stabilizer
2. **STITCH COLOR 1.** This will outline the head shape onto the stabilizer as a placement guide. Note the arrow showing direction of stretch for your fabric.
3. Place the front piece of the head fabric over the placement area you just stitched with the **RIGHT SIDE UP.** {don't place the fabric for the back of the head yet}
4. **STITCH COLOR 2** which tacks down the head fabric.
5. **STITCH COLOR 3** to create the face detail. The machine will finish with a few stitches at the right ear for placement purposes.

NOTE: if you're not including ears, advance your machine to color 6 and skip to step 9 below.

6. Place an ear in the ear box on the right that was created by the tackdown stitches (color 2). The stem of the ear should fit in the box, and the ear detail stitches should be facing down (right sides together)
7. **STITCH COLOR 4** to tackdown the right ear. The machine will then create long stitches to travel to the left ear.
8. Repeat the ear placement with the left ear and **STITCH COLOR 5** to tackdown the left ear.
9. {Optional} Remove hoop from machine but keep project in the hoop. Add tiny bits of stuffing to nose, cheeks, chin or brow to create more character in the face. You will need to clip the basting stitch at the top of the head for this.
10. Place the back head fabric **RIGHT SIDE DOWN** to cover the outline of tackdown stitches.
11. Place a piece of no-show mesh stabilizer over the back of the head .
12. **STITCH COLOR 6** to create the head seams. These will be double stitched.

Head Stitch-out is done!

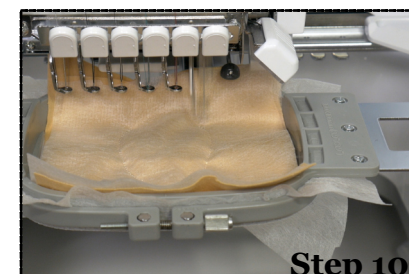
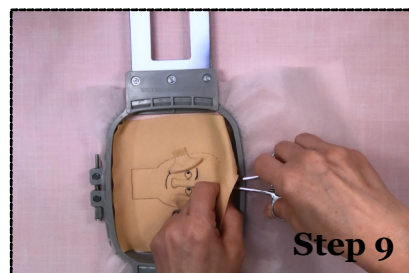
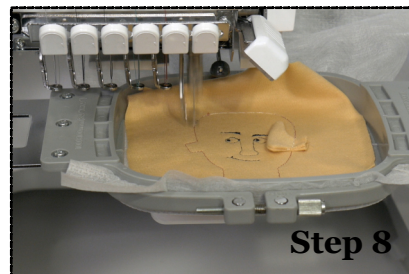
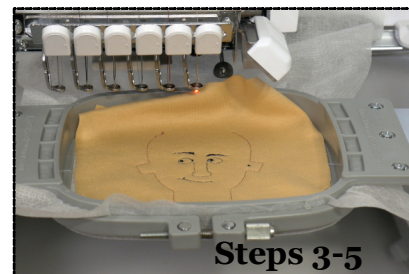
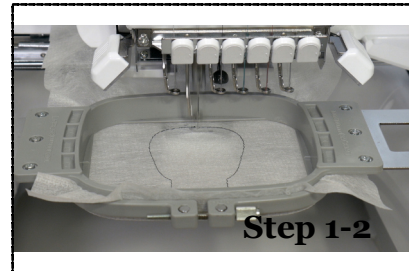

INSTRUCTIONS: STITCHING THE BODY

1. Hoop no-show mesh stabilizer
2. **STITCH COLOR 1** to create a placement outline on your stabilizer. Note the arrow showing direction of stretch for your fabric.
3. Place body front fabric over the placement stitches with **RIGHT SIDE UP**
4. **STITCH COLOR 2** which will tack-down the fabric with an outline of the body..
5. (Optional) if you're going to add your own design to the front of the doll body - this is where you can do that.
6. Place the back fabric over the front, with **RIGHT SIDE DOWN**. (right sides together)
7. Cover the back fabric with another piece of no-show mesh stabilizer . This will stabilize the stretch fabric when we stuff the doll. **NOTE:** if you're making the small doll body in 5x7 hoop - cut away the stabilizer from the hands and feet area so it will turn more easily later on.
8. **STITCH COLOR 3**. This will double stitch the seams of the body.
9. Remove hoop from your machine. Trim away excess threads from front and back if your machine didn't do that for you already.

The stitch-out of the body is done!

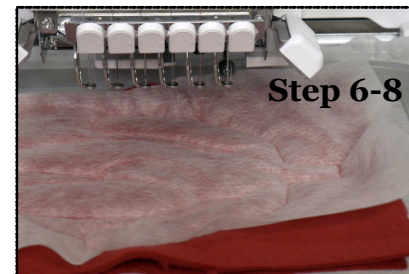
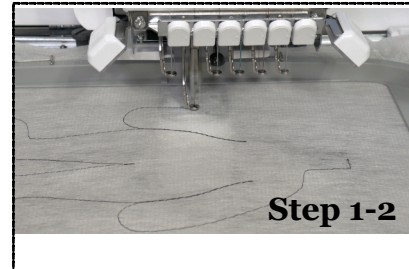

INSTRUCTIONS: STITCHING HANDS

Note: hands are not available for small dolls made in 5x7 hoops

1. Hoop some water or heat soluble stabilizer. If you don't have that, you can use tear-away stabilizer instead.
2. **STITCH COLOR 1** to create a placement outline on your stabilizer. Note the arrow showing direction of stretch for your fabric.
3. Place **BOTH** top and bottom layers of your hand fabric in the hoop to cover the placement guide. The stretchiest direction of your fabric should follow the arrow from step 2
4. **STITCH COLOR 2** to double-stitch the seams for the hands.

Hand stitch-out is done!

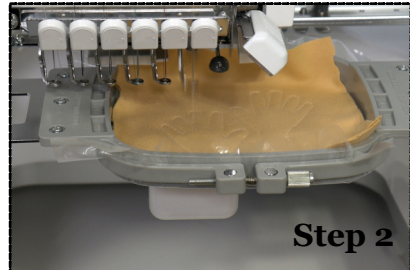
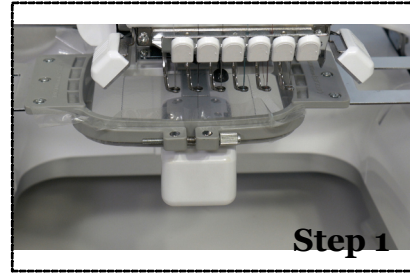

INSTRUCTIONS: STITCHING THE HAT

1. Hoop some tear-away stabilizer.
2. **STITCH COLOR 1** to create a placement outline on your stabilizer. Note the arrow showing direction of stretch for your fabric.
3. Place your hat fabric **RIGHT SIDE UP** in the hoop to cover the placement guide. The stretchiest direction of your fabric should follow the arrow from step 2
4. **STITCH COLOR 2** to create a fold line down the middle
5. Fold the left side over the right at the fold line. You should be able to see the stretch arrow on the stabilizer.
6. **STITCH COLOR 3** to double-stitch the seam for your hat.

Hat stitch-out is done!

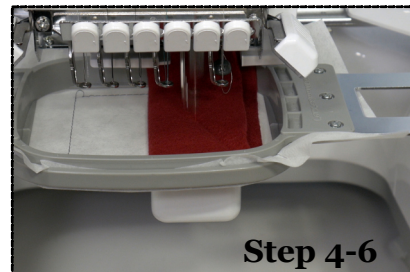
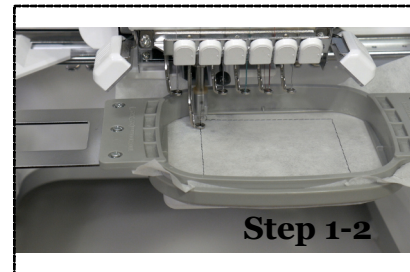

INSTRUCTIONS: CUTTING & TURNING

Cut away the excess fabric from the seams of all the parts you stitched. Use these tips for cutting:

- The body and head placement guides can be used as a cutting guide on those parts. (figure 1)
- The body needs to be cut open with a vertical slit in the stabilizer and back fabric. (figure 2) Cut from bottom of neck, down to the 1/4" from crotch area. You will stitch this closed later.
- For the hat, leave the fold intact and cut the excess from the seam. Then cut a curved edge from the fold to the seam at the bottom of the hat. (figure 3)
- Since you used non-fray stretch fabrics, you can cut a scant 1/8" seam allowance on all the parts.
- Be sure to clip into any sharp corners so the fabric is cut close to the stitch line without cutting the seams. This will ensure the doll turns with sharp corners. Pay close attention to the neck, armpits, crotch, ankles and between each finger.
- The hands and ears need to have very little seam allowance so they can turn properly. View the photos for an idea on how close to cut your stretch fabrics. (figure 4)
- After cutting out the parts, they should look similar to figure 5
- Use very sharp scissors!! And be careful!!

Turn all the parts right side out.

- It's recommended to use small nose hemostats to turn the fingers.
- Larger hemostats are useful for turning the arms and legs.
- Always start with the smaller parts that are further away for best results.

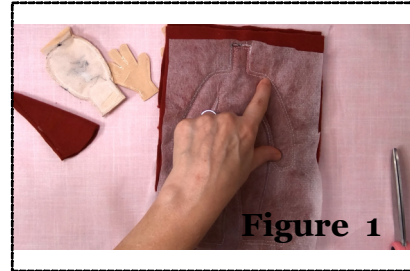

Figure 1

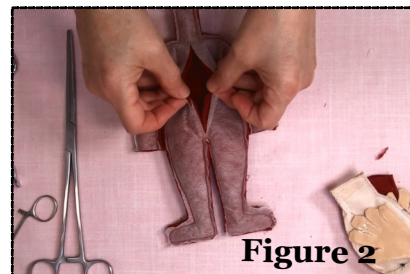

Figure 2



Figure 3

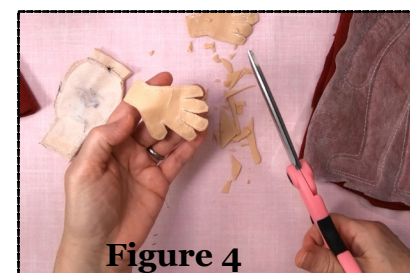

Figure 4

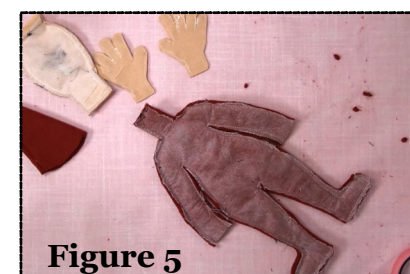

Figure 5

INSTRUCTIONS STUFFING AND EMBELLISHING THE DOLL

1. {Optional} Insert wire armature if you're including one. Armature diagram can be found on following pages.
2. Stuff the head and body with fiberfill. You can stuff firmly or lightly - it's your doll..
3. Close the hole in the body either by hand stitching with a doll needle and heavy thread, or by using fabric glue. (ladder stitch diagram is on following pages)
4. Slide the neck into the head in the chin area or back head flap. Glue or hand-stitch the head onto the neck.
5. Add hair to the head using your choice of wiggig method.

Embellish your new cloth character with face coloring, clothing, accessories or whatever your creative genius desires! One method for an elf is shown here in the photos to the right

1. Glue a 4" by 1/2" strip of scrap fabric over the front seam of the doll to create a placket.
2. Glue Fur Yarn trim to the doll cuffs, neck and hipline to create the look of a fur-trimmed coat.
3. Hand-stitch tiny buttons to the placket.
4. Glue mohair locks to the dolls head along with the hat and tuck locks under the hat until you like the look.
5. Apply some glue into the opening in the head and slide it onto the neck stem. Position the head where you want it, then let the glue dry.
6. Use a fine-tip white paint marker to fill in the whites of the eyes (optional)



INSTRUCTIONS FOR WIRE ARMATURE

Wiring the doll is completely optional!

These instructions are for a wired doll that can stand and pose on it's own. For a light version of wiring, you can use pipe cleaners or chenille stems to create light poses in your doll or leave the doll unwired.

The measurements below are for the medium cloth character (body made in 6x10 hoop). Use more or less wire and use your doll body as the pattern to modify armature sizes.

For the body armature

1. cut 24" of thick armature wire for neck/body/legs
2. bend in half, then twist to form the upper body like the diagram on next page
3. using pliers bend the hips and feet to match the diagram
4. use wire cutters to clip excess from the feet
5. secure the hip area and heels with tape such as duct tape or electrical tape

Form & attach the arms armature

6. cut 24" of thin armature wire for arms
7. create a loop like in the diagram on next page
8. twist the overlapping edges twice to close
9. grab the "hand" loops and twist until tight and the entire "wingspan" is 10" long
10. attach the excess wire in the middle of the arms to the body where shown by twisting around the body armature
11. cover the arm attachment area with electrical tape or duct tape so no sharp ends can poke out. You can also tape some batting over areas to pad them.

NOTE: It's best to leave the legs & feet straight until the armature is inserted into the cloth body, then you can bend the ankles to form the feet. It's easier that way.

In order for the doll to stand -press the foot loops so they are flat against the surface they're standing on, then balance the doll. Play around with foot positions until the doll stands firmly without wobbling.

WARNING! Wired dolls are not intended for small children! The wires could come out and pose a hazard, or the child may repeatedly bend wires to the point where they break. Only insert wire armatures when the doll is not intended to be played with by young children.

MEDIUM DOLL ARMATURE DIAGRAM

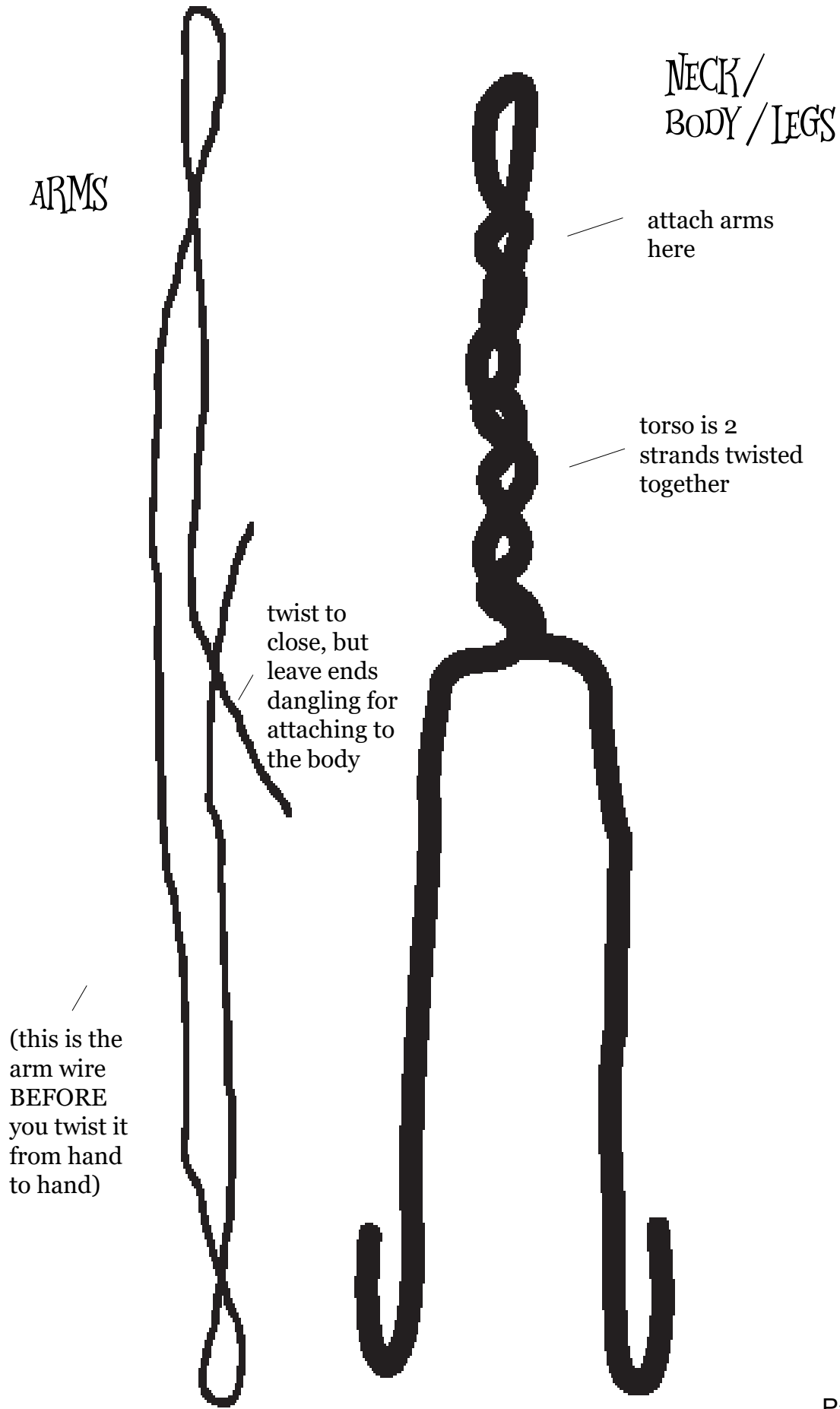

Ladder stitch:

1. Thread a long needle with a double layer of strong thread that is about 12" long and tie a knot at the end.
2. Starting at the inside of the doll - push the needle and thread from the inside to the outside at one end of the seam opening.
3. Take a horizontal stitch across the seam opening and insert the needle again, it should come out about $\frac{1}{4}$ " down that same side. If you have stabilizer under your fabric, be sure to catch the stabilizer in your stitch.
4. Then do another horizontal stitch going the opposite direction across the seam opening.
5. Repeat this stitch pattern. It resembles railroad tracks. The horizontal arrows in the diagram are stitches on top of the fabric, while the vertical dashed arrows are underneath and not seen.
6. When you pull on the thread, it should pull the opposite sides together to close the gap.
7. When you have stitched the entire seam, make a knot in the thread and then push the needle back into the doll to come out a few inches away and cut the thread so it disappears back inside the doll stuffing areas. Now your thread is secure and buried where nobody can see it.

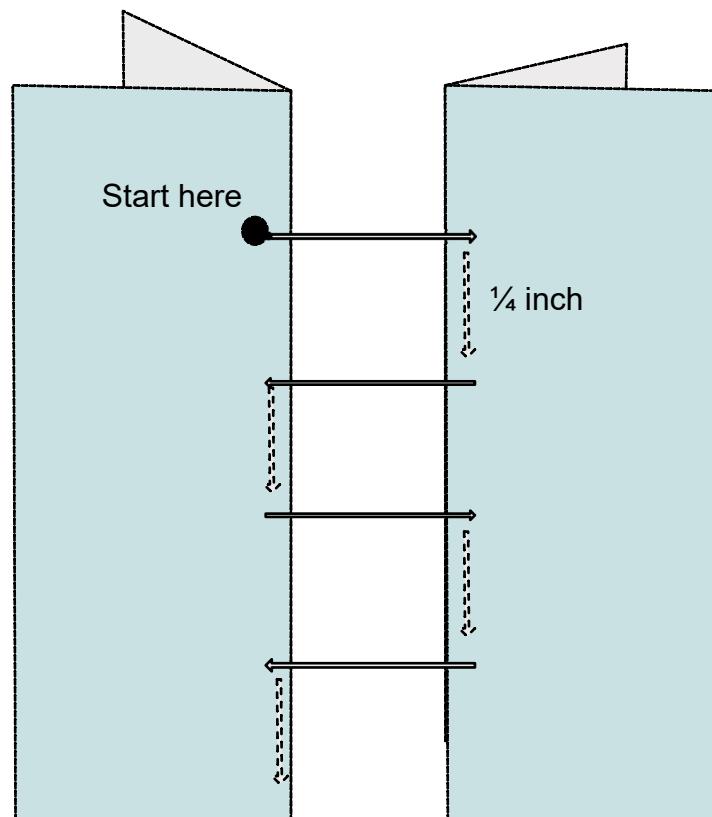

Design Details: Ears

BC_4x4_CC-med_ElfEars
76.1x51.2 mm (3.00x2.02")
483 st,
3/3 clrs,

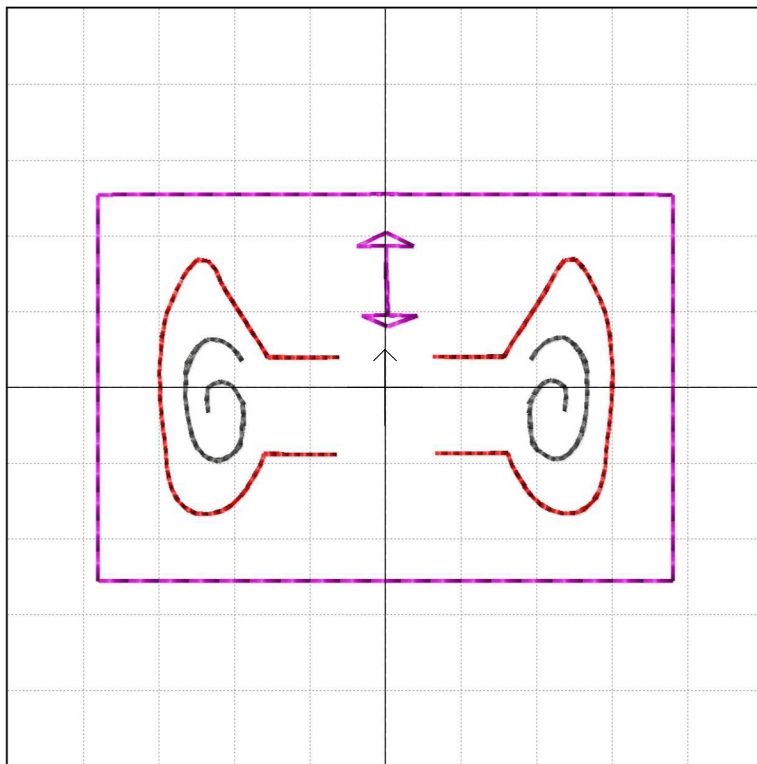
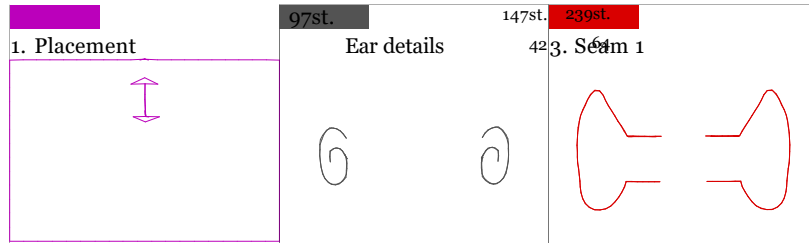

Design Details: Hands

BC_4x4_CC-med_Hands
98.2x98.6 mm (3.87x3.88 ")
1044 st
2/2 clrs

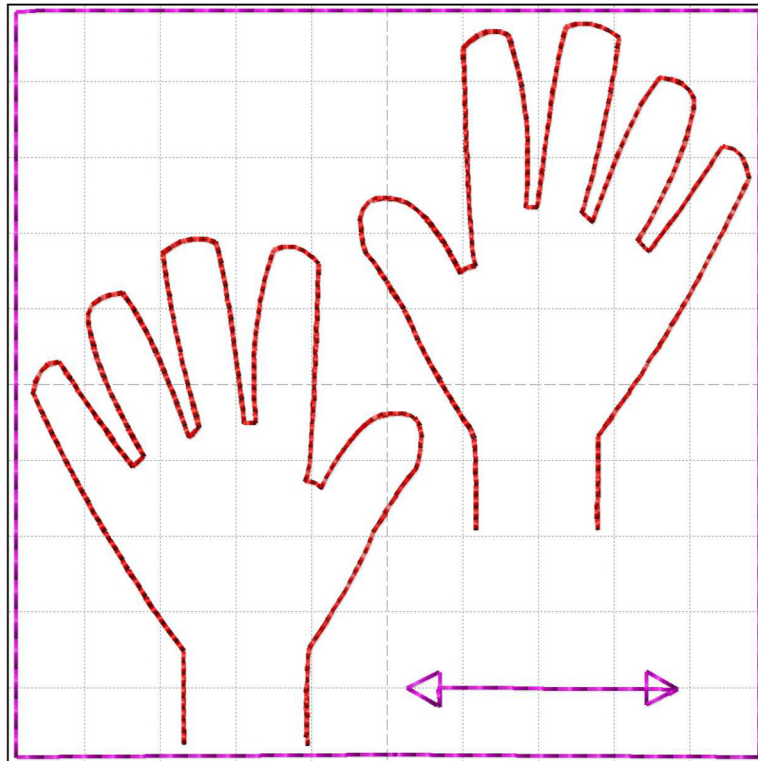
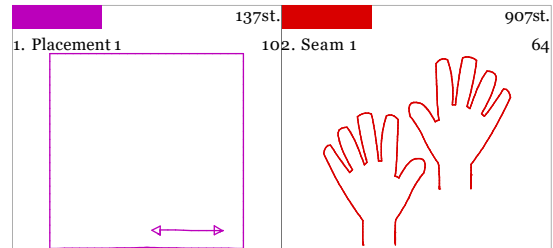

Design Details: Head

BC-4x4-ITH--ElfDoll-head.

72.0x100.1 mm

947 st

5/6 clrs

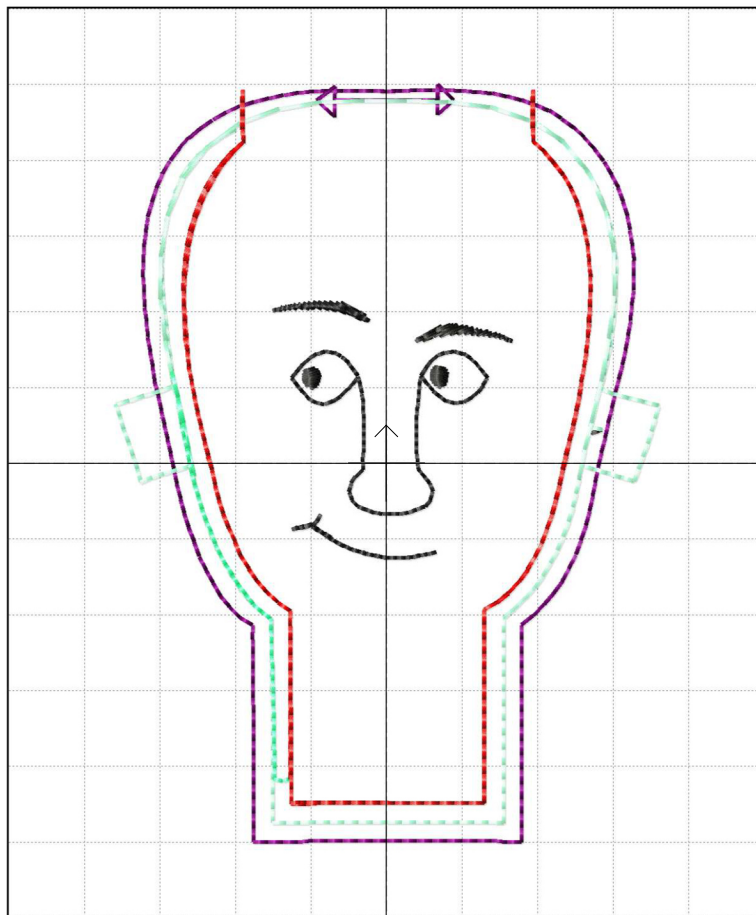
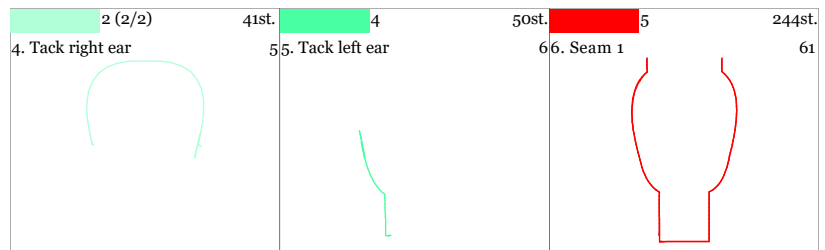
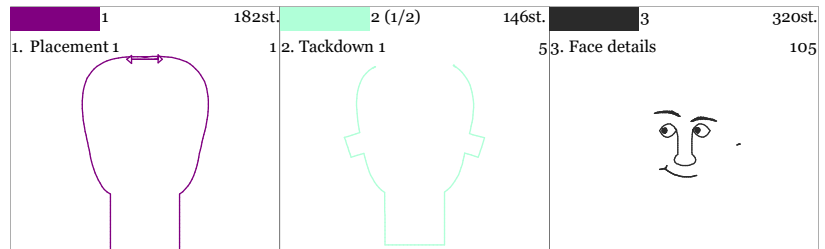

Design Details: Body

BC-6x10-ITH-med-ElfDoll-body.eof

147.8x235.1 mm

1850 st,

3/3 clrs

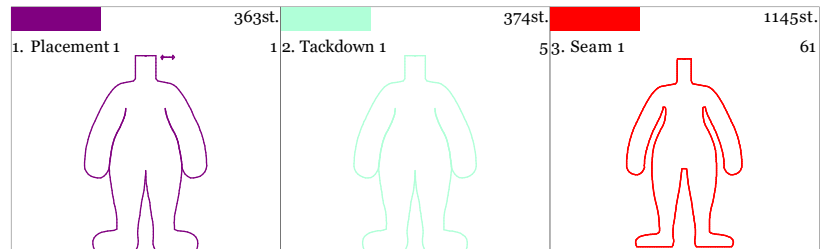

Doll Body Template on next page

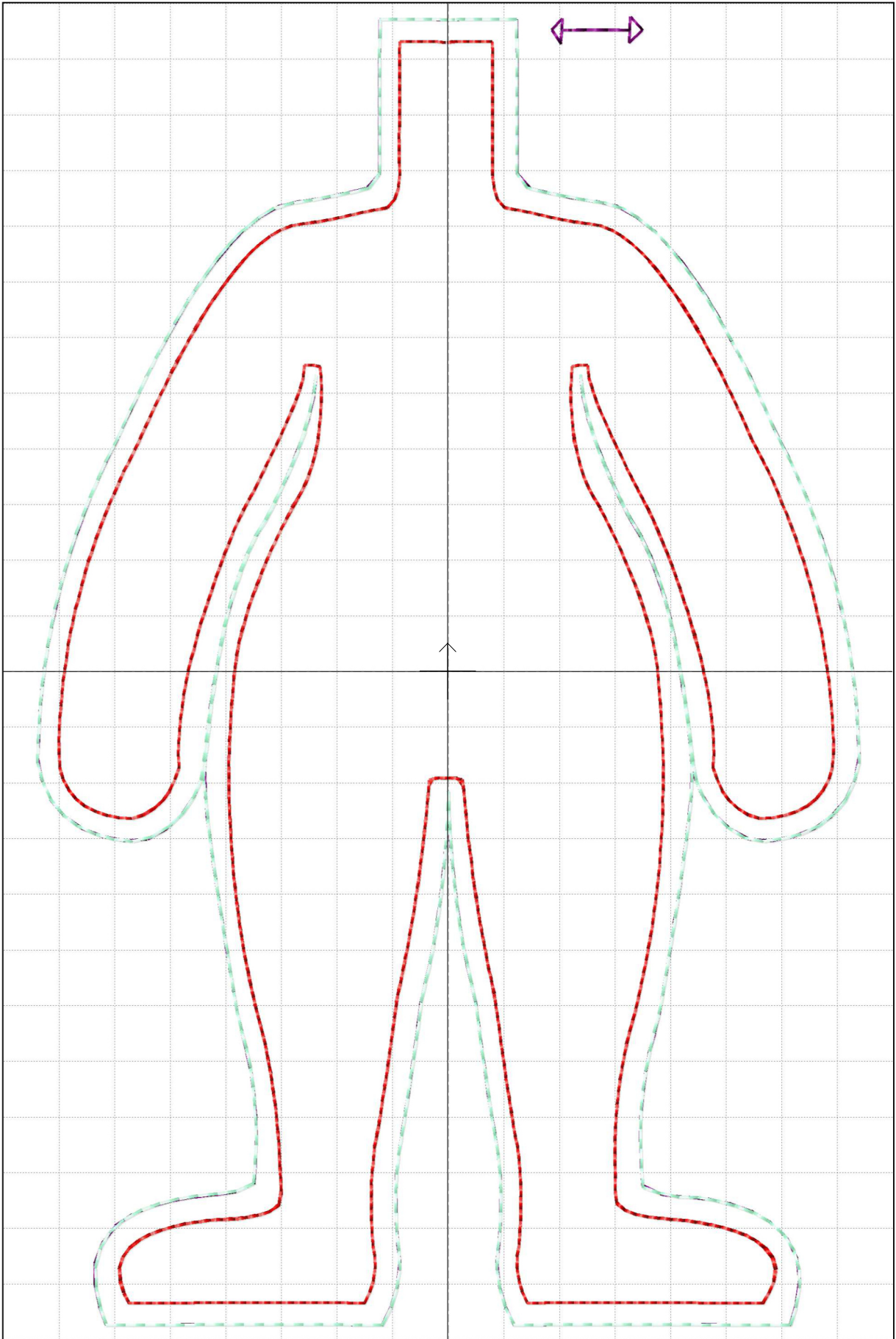

Design Details: Hat

BC-4x4-ITH-med-ElfHat.
 96.0x98.4 mm
 265 st
 3/3 clrs

